



jordanfishwick

Barnett Street

£825 PCM



Barnett Street, Macclesfield, SK11 8JB

£825 PCM

Situated on a cobbled backwater street of Macclesfield and conveniently located within easy reach of the town centre and close to local amenities is this extremely attractive one bedroom cottage.

Offering good sized accommodation over two floors and with the added benefit of a cellar along with gas fired central heating and double-glazed windows and private garden this well-presented cottage is ideal for the single professional or couple

AVAILABLE LATE FEBRUARY PART FURNISHED In brief the property comprises living room with multi fuel stove leading to modern fitted kitchen with gas cooker, washing machine, fridge freezer and access to rear garden and cellar.

To the first floor there is a good-sized double bedroom and a bathroom.

To the rear of the property is a pleasant small courtyard garden

Contact Macclesfield 01625 502222 £825.00pcm

COUNCIL TAX A

EPC D

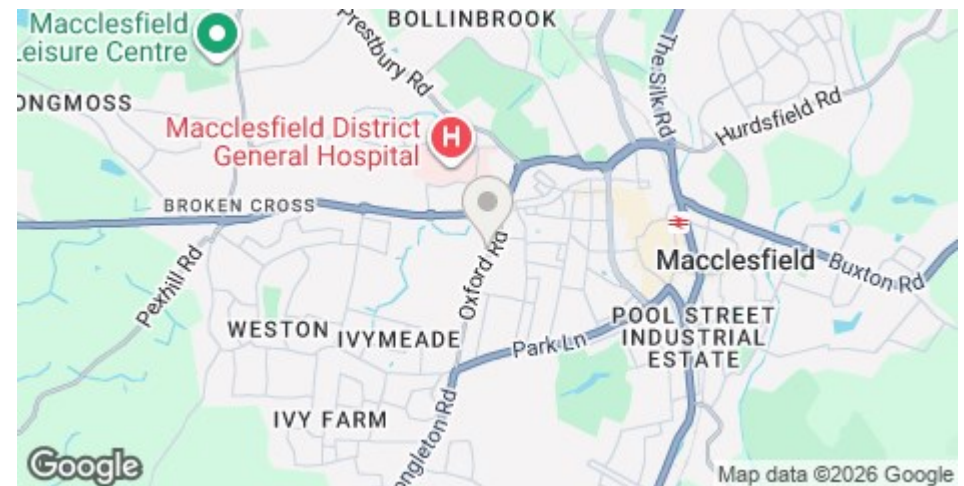

- ONE DOUBLE BEDROOM
- EXTREMELY ATTRACTIVE INTERIOR
- MODERN FITTED KITCHEN
- COURTYARD GARDEN
- MULTI FUEL STOVE
- CELLAR
- COUNCIL TAX A
- EPC D

Postcode - SK11 8JB

EPC Rating - D

Floor Area - sq ft

Local Authority - Cheshire East

Council Tax - A



CELLAR

GROUND FLOOR

1ST FLOOR

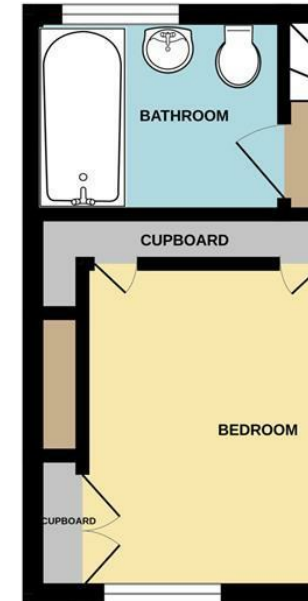
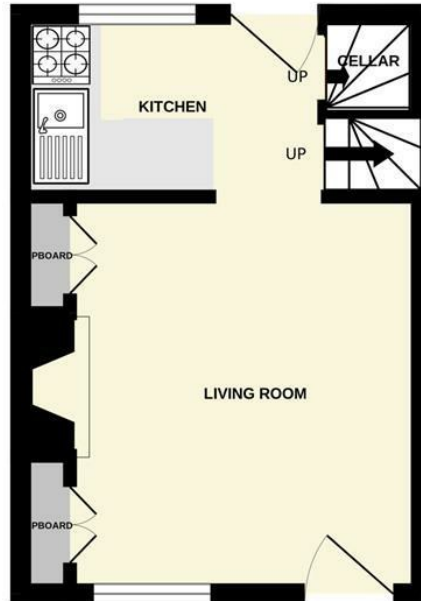
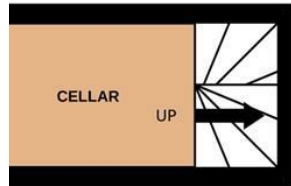

Measurements are approximate. Not to scale. Illustrative purposes only
Made with Metropix ©2025



These particulars are believed to be accurate but they are not guaranteed and do not form a contract. Neither Jordan Fishwick nor the vendor or lessor accept any responsibility in respect of these particulars, which are not intended to be statements or representations of fact and any intending purchaser or lessee must satisfy himself by inspection or otherwise as to the correctness of each of the statements contained in these particulars. Any floorplans on this brochure are for illustrative purposes only and are not necessarily to scale.

Offices at: Offices at Chorlton, Didsbury, Disley, Hale, Glossop, Macclesfield, Manchester Deansgate, Manchester Whitworth Street, New Mills, Sale, Wilmslow and Withington

01625 536300